

# Abbaye aux Dames la cité musicale, Saintes



Les chambres  
de l'Abbaye aux Dames

*Welcome !*

# DEAR VISITOR,

Thank you for choosing to stay overnight  
at the Abbaye aux Dames, la cite musicale.  
We wish you an excellent visit.  
We hope you find this practical information  
leaflet useful.

If you're looking for a souvenir why not visit  
our shop at reception.

By choosing the Abbaye aux Dames,  
la cite musicale you are supporting  
our cultural activity and contributing  
to the upkeep of this historical site.

---

## CONTACTS

Marysia Pepe / Karine Ségui

05 46 97 48 33

[reservations@abbayeauxdames.org](mailto:reservations@abbayeauxdames.org)

[chambres.abbayeauxdames.org](http://chambres.abbayeauxdames.org)

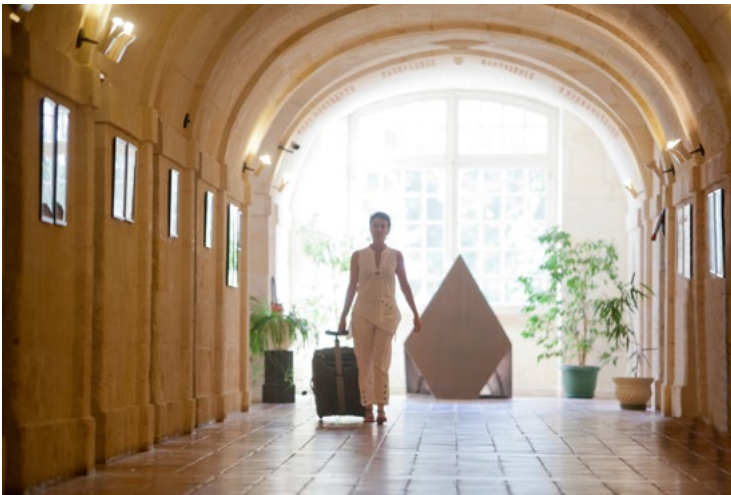

# ARRIVING BY CAR

GPS Lat 45.743681 Long -0.624375

Motorway A10, exit 35

-after the toll booth take the right lane towards Angoulême

-take the first exit and at the first roundabout take the 5<sup>th</sup> exit, you are now on Avenue Saintonge

-straight over the 2<sup>nd</sup> roundabout

-straight over the 3<sup>rd</sup> roundabout - you will go over the river Charente

-at the 4<sup>th</sup> roundabout take the 3<sup>rd</sup> exit towards the Abbaye aux Dames

-at the 5<sup>th</sup> roundabout take the 2<sup>nd</sup> exit

The free car park is in rue Geoffroy Martel

# ARRIVING BY TRAIN

From the train station

- at the roundabout go along avenue de la Marne

- turn right along avenue Gambetta

- continue until you can turn left along rue de Pérat

- at the end of the street turn right along rue Saint-Pallais

After a few meters you will find the Abbaye aux Dames on your left.

# BUS

Town buses 0800 17 10 17 / [www.buss-saintes.com](http://www.buss-saintes.com)

## HOTEL ENTRANCE

Having arrived at the Abbaye aux Dames

- Before 8pm, register at reception.
  - After 8pm, our caretaker will be waiting for you with your keys.
- Tel (0033)603548323

## AT YOUR DISPOSAL

- Safety deposit at reception available upon request,
- Iron and ironing board available upon request
- Hair dryer available upon request (with 10€ returnable deposit)
- Bicycle storage available

## MUSICAVENTURE – A MUSICAL EXPERIENCE

Take a musical break with 3D sound : Sound Journey, Carrousel, audio-guided visit, Spatialised Concert, Sound Siesta, Virtual Festival

Free for all hotel guests

Information and reservations at reception : 05 46 97 48 48

## TOURIST INFORMATION

- on our website under heading "Cycling and hiking" : [chambres.abbayeauxdames.org](http://chambres.abbayeauxdames.org)
- at the tourist office : [www.saintes-tourisme.fr](http://www.saintes-tourisme.fr)

## PLAN OF THE ABBAYE AUX DAMES

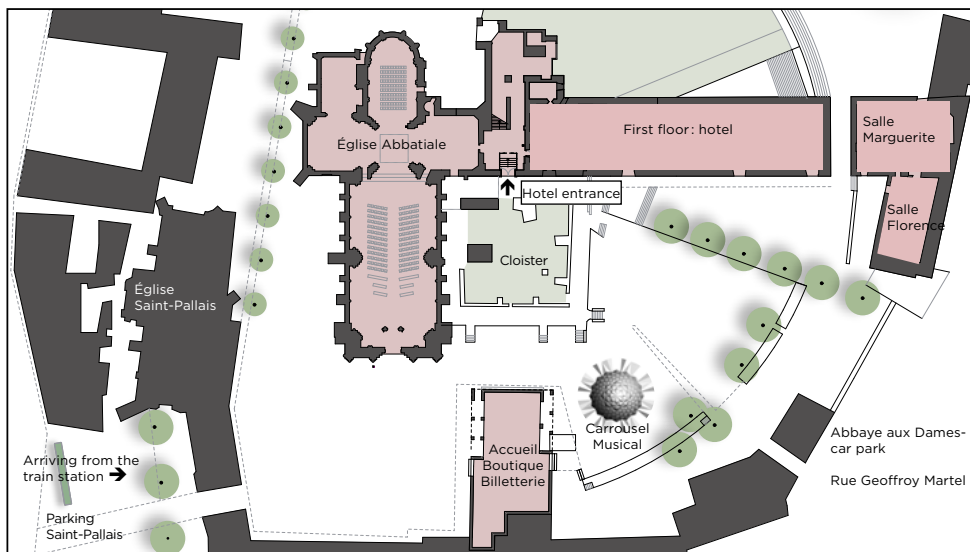

# DAY OF DEPARTURE

- departure before 10am
- please leave your key-card in the deposit box by the door just before you leave the hotel.

# IN CASE OF EMERGENCY

- it is possible to contact the caretaker on: 06 03 54 83 23  
(or emergency services on 112)

# BREAKFAST

- is served in "salle Florence" 7am to 10am, a room on the ground floor on your right as you go down the stairs opposite room number 117.

## SAINTES MAP

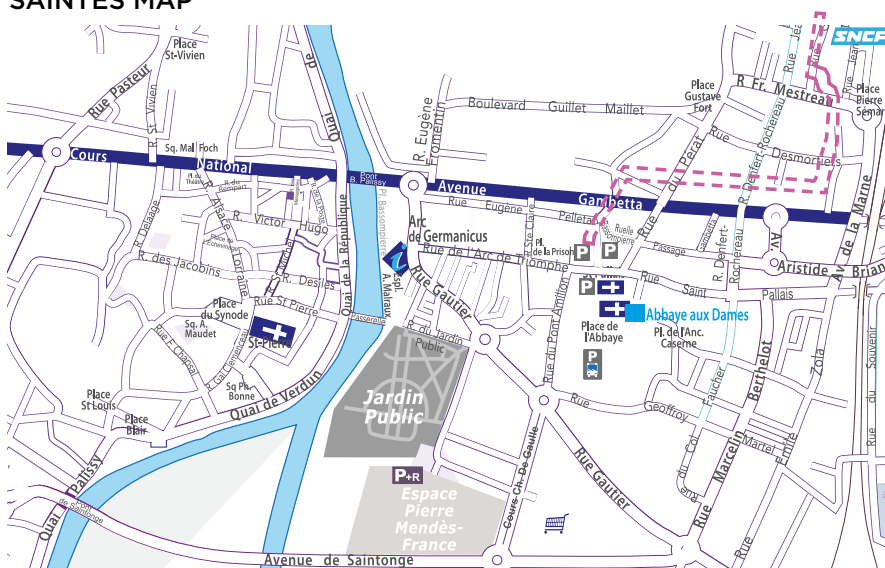

# YOUR ROOM KEY

Whenever you leave your room please be sure to take a key-card with you as you will need it to reopen the door. The door is fitted with a mechanism which ensures that it closes firmly.

---

The Abbaye aux Dames takes care to respect the environment:

- rubbish sorting and recycling, garden maintenance without pesticides, water economisers fitted on taps, responsible use of cleaning products...

LES **CHAMBRES** DE L'ABBAYE  
AUX DAMES EVOKE AN  
ENCHANTING MIX OF HISTORY,  
ARCHITECTURE AND MUSIC ALL  
BATHED IN THE SPECIAL LIGHT  
OF THE SAINTONGE REGION.

Join us on Facebook

[www.facebook.com/chambres.abbayeauxdames](http://www.facebook.com/chambres.abbayeauxdames)

Why not evaluate your visit on Tripadvisor... ?

[location.abbayeauxdames.org](http://location.abbayeauxdames.org)

[chambres.abbayeauxdames.org](http://chambres.abbayeauxdames.org)

@abbayeauxdames

